

## DynamicX2BarConnect

Aluminium retractable motorised monitor with connections bar

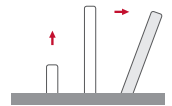

### FEATURES

- Motorised monitor with integrated AV connectivity
- Automatic 20° inclination
- Interactive Setup Display
- Customisable cover plate
- Compact, space optimising and elegant solution
- HDCP compliant
- Energy saving design and Security system
- Easy installation
- Maintenance free and durable solution
- Serial control and remote diagnose
- AH-AMMC Auto Mechanical Movement Calibration
- Ideal for tables, desks and lecterns

### GENERAL

DynamicX2 monitor is combined with BarConnect, a motorised, retractable connection system. This combination offers the best possible quality Full HD screen and personalised connectors options like HDMI, power USB, RJ45 USB and power outlets. The ergonomic angle of the bar enhances comfort and usability. A safety mechanism stops the system in case of obstruction. The design is simple, with just 4 operation buttons. It is intuitive and easy to install. It offers cable management, improved table space and a neater environment.

DynamicX2 are elegant monitors built from a solid aluminium block and have a vertical motorised movement with automatic 20° inclination to ensure the best ergonomics, viewing angle

and visibility. This automatic tilting system provides a fast and silent response. It is a reliable, maintenance-free solution. DynamicX2 have slightly curved edges for a contemporary and longstanding look. The range is available from 15" to 22".

The anodised aluminium housing can be customised in different colours and finishes. The standard top-table cover plate is made of brushed stainless steel. It can optionally be supplied with a matt finish or it can disappear when the product is prepared for underneath installation.

DynamicX2 monitors are remotely controllable and diagnosable through the ERT interfaces in an easy and cost effective way.

ARTHUR HOLM

Albiral Display Solutions SL · Fàtima, 25 Sant Hipòlit de Voltregà 08512 Bcelona, Spain · +34 938 502 376 · marketing@arthurholm.com  
www.arthurholm.com

Arthur Holm is a registered brand of Albiral Display Solutions SL. Specifications subject to change without previous notice.

## MONITOR - TECHNICAL SPECIFICATIONS

**AH15DX2HDGA/BC**

### Display

Size	FULL HD 15.6" TFT Active Matrix
Resolution	1920 (h) x 1080 (v)
Brightness	400 cd/m2
Contrast ratio	1500:1
Pixel	0.1792 (h) x 0.1792 (v) mm
Viewing angle	85°/85° (u/d) / 85°/85° (l/r)
Viewing area	344.16 (h) x 193.59 (v) mm
LED backlight lifespan	70,000 hrs
Response time	Tr + Tf 35 ms
Temperature (operating/storage)	Operating 0°C – +40°C Storage -20°C – +60°C

### Materials

Frame	Anodised Aluminium
Glass	AR 2-side with an anti-reflective coating on the glass surface. Thickness: 3.0 ± 0.3 mm
Cover plate	Stainless steel or matt

### Connectivity

Input signal	DVI-I (1 input) Digital / Analogue DVI-D (1 input) Digital HDCP compliant
RJ45 CAT6 (with loop)	Addressable RS422 monitor control by AHnet protocol
GPI (SubD9)	Up/Down control

### Control

RJ45, RS-422 (I/O)	
Addressing	
Termination switch	
GPI	
IR Remote control (monitor adjustments):	1 / 5

### Movement's Control

User interface on monitor	(Up/Down)
Remote	RS-422 I/O/GPI

### Electrical

Low voltage (external power supply)	100-240Vac, 47/63Hz, 12Vdc
Power consumption	40W

## BARCONNECT - TECHNICAL SPECIFICATIONS

### Connectivity

RJ45 CAT6 (with loop)	Addressable RS422 monitor control by AHnet protocol
Connectors	USB
	Power USB
	Power outlet
	RJ45
	HDMI

### Engine

Control Up/Down	Buttons on cover plate, RS422 (RJ45 CAT6)
Electronic control	PWM

### Electrical

External power supply	100-240 Vac, 47/63Hz, 12Vdc
Power consumption	10W

## DYNAMICX2BARCONNECT - MECHANICAL

### Monitor Dimensions

Screen	403 x 234.16 x 25 mm [15.87" x 9.22" x 0.98"]
Upper Cover Plate	500 x 228.6 mm [19.68" x 9"]
Housing below the table	485 x 590 x 80 mm [19.09" x 23.23" x 3.15"]
Weight	24 kg / 52.9 lbs

### Shipping Dimensions

Weight	25 kg / 55.1 lbs
Shipping Box	575 x 305 x 670 mm

## CERTIFICATIONS

- CE

## WARRANTY

- 5 years limited warranty
- 2 years general warranty

ARTHUR HOLM

Albiral Display Solutions SL · Fàtima, 25 Sant Hipòlit de Voltregà 08512 Bcelona, Spain · +34 938 502 376 · marketing@arthurholm.com  
www.arthurholm.com

Arthur Holm is a registered brand of Albiral Display Solutions SL. Specifications subject to change without previous notice.

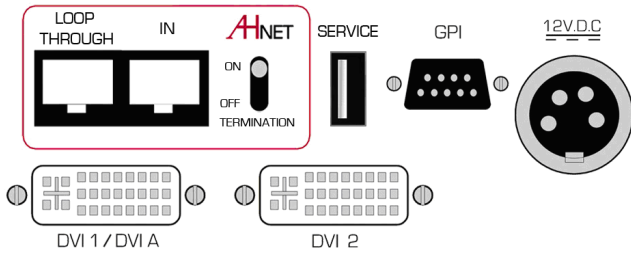

BARCONNECT CONNECTIVITY PANEL

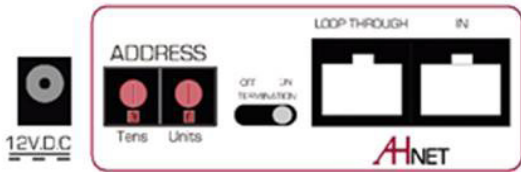

INTERACTIVE SETUP DISPLAY

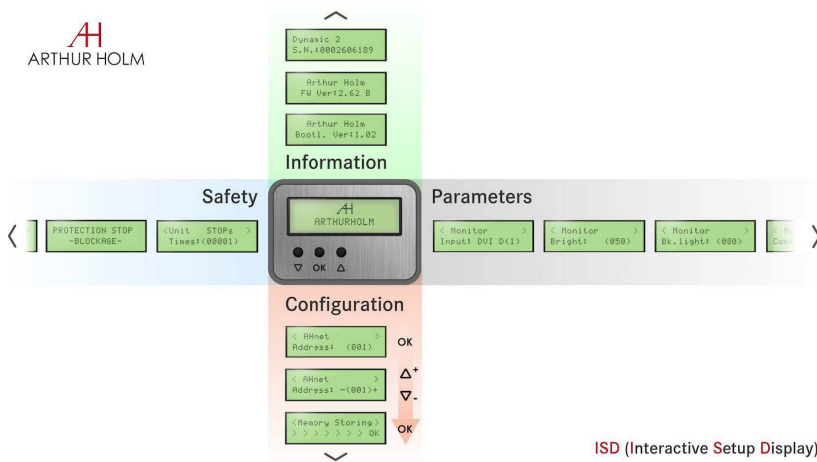

ISD (Interactive Setup Display)

ARCHITECT’S SPECIFICATIONS

Low voltage professional electrically retractable 15.6” FULL HD monitor with 20 degrees of automatic inclination. Solid block of aluminium monitor housing in natural anodized finishing, with rounded corners design. Front double sided anti-reflective 3 mm black-edged glass. Passive opening cover plate for enhanced reliability. DVI-I and DVI-D connectors, HDCP compliant inputs.

Retractable motorised connection box including 1 USB, 1 power USB, 1 power outlet, 1 RJ45 and 1 HDMI connector.

Compatible with AHnet open protocol over RS-422, allowing individual remote control of up to 30 units per line over a daisy chain CAT-6 line and control up to 900 monitors

using the AHnet Control System. Additional control by means of the buttons integrated on the cover plate that can be activated or deactivated by using the AHnet protocol. Easy to read Interactive Set-Up Display (ISD) LCD display for address setup and status monitoring. Dual Pulse Time safety system that detects obstructions, stopping the unit. External power supply with 4-Pin XLR4 connector.

Bottom connectivity for easy access and removal of monitor. Monitor housing total depth is 590 mm, plus additional spacing for connectors. Adjustable parameters through AHnet or ISD allowing calibration and adjustment of mechanics. Diagnostic readout on ISD for service and support.

GENERAL DIMENSIONS

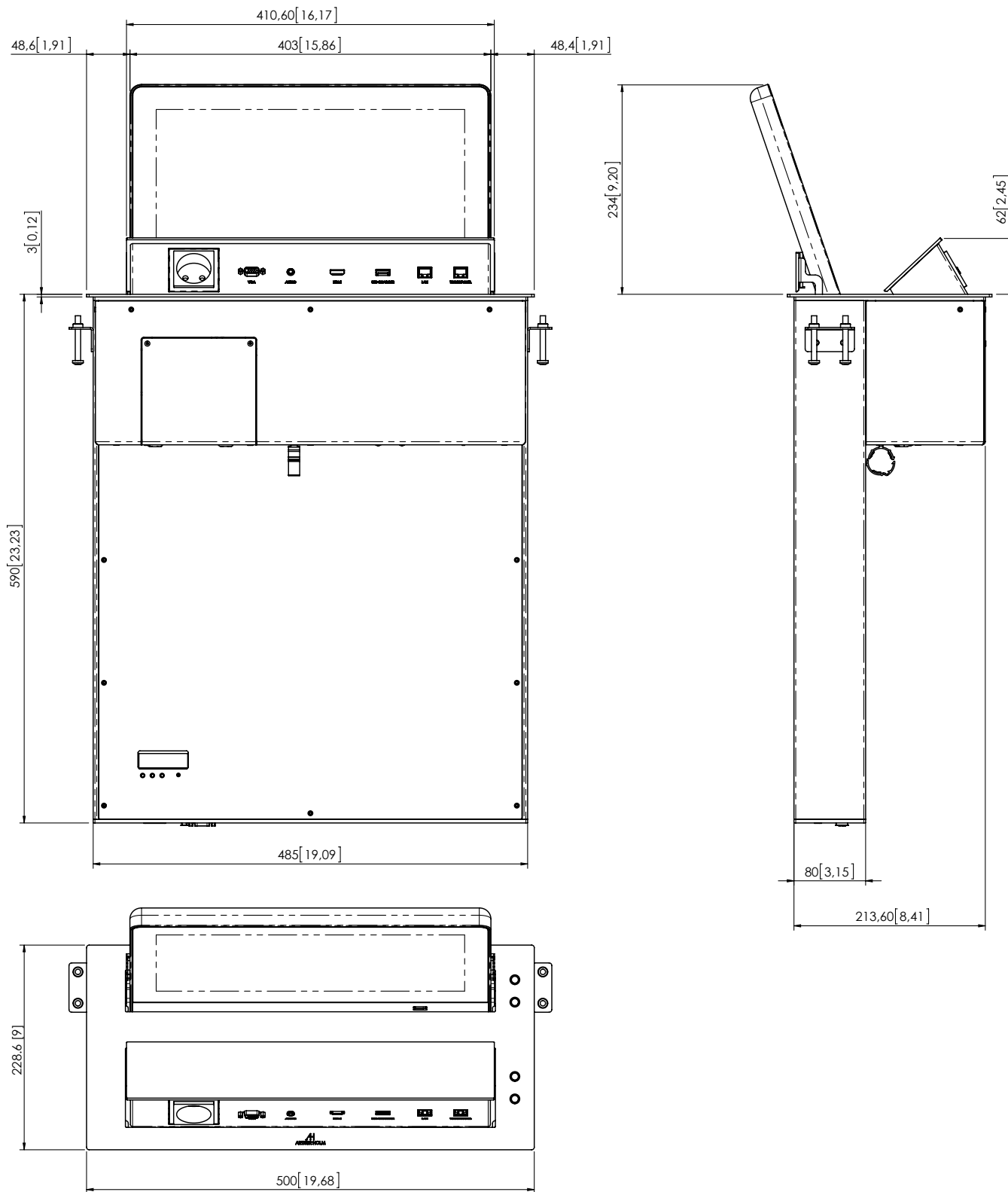

ARTHUR HOLM

Albiral Display Solutions SL · Fàtima, 25 Sant Hipòlit de Voltregà 08512 Bcelona, Spain · +34 938 502 376 · marketing@arthurholm.com  
www.arthurholm.com

Arthur Holm is a registered brand of Albiral Display Solutions SL. Specifications subject to change without previous notice.