

DB2

Aluminium retractable motorised monitor

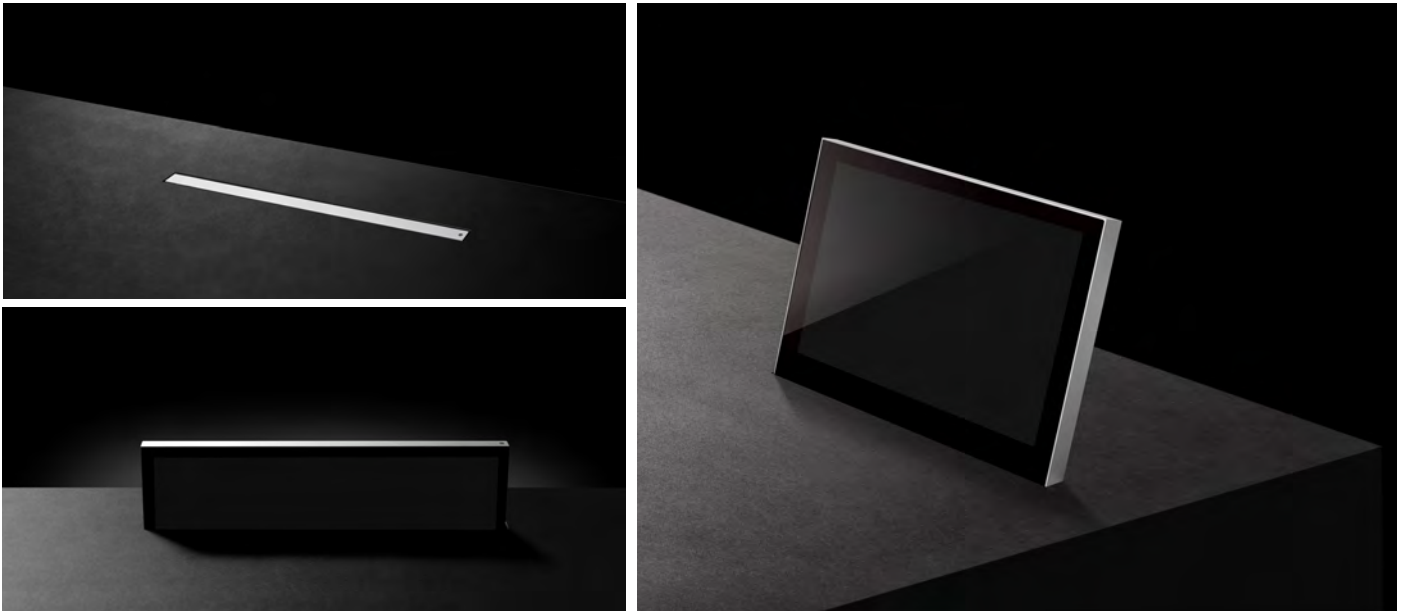
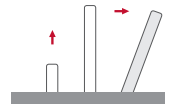

FEATURES

- Vertical motorised monitor with up to 20° inclination
- Adjustable screen angle tilt
- No cover plate required (monitor is completely streamlined within the furniture)
- One touch sensor on the top of the aluminium housing (to raise and lower the screen and adjust the tilt angle)
- 20 mm. monitor depth
- Front double sided anti-reflective 2mm black edged glass
- Can be veneered
- Interactive Setup Display
- Maintenance free
- HDCP compliance
- Energy saving design, low consumption video controller
- Serial control and Remote diagnosis
- Individual monitor addressing
- AH-AMMC Auto Mechanical Movement Calibration

GENERAL

Arthur Holm's DB2 is a new retractable monitor range that creates minimum impact on the furniture design (just 20 mm. of depth): easy to integrate, intuitive to use (one simple operation sensor) and almost invisible (no cover plate, streamlined neatly into the furniture) when not in operation. The monitors are elegant, beautiful from all angles, and discreetly integrated into the meeting room table, disappearing within the desk with a harmonious silent drive.

Completely designed and furnished in anodised aluminium, the range offers a minimal and contemporary look.

Aluminium is a durable surface; it is extremely resilient and it also serves to dissipate heat, plus the anodised finish provides a soft, silky effect. The front anti-reflection double glass protects the screen, reduces the "mirror" effect, increases the contrast and allows for natural transparent colours.

The range is available from 10" to 23.8" and there is a touch screen option (from 10 to 22"). DB2 monitors are remotely controllable and diagnosable through ERT interfaces in an easy and cost-effective way.

TECHNICAL SPECIFICATIONS

Display

Size	FULL HD 17.3" LED
Resolution	1920 (h) x 1080 (v)
Brightness	400 cd/m2
Contrast ratio	600:1
Pixel	0.1989 (h) x 0.1989 (v) mm
Viewing angle	60°/80° (u/d) / 80°/80° (l/r)
Viewing area	381.888 (h) x 214.812 (v) mm
LED backlight lifespan	50.000 hrs
Response time	Tr 37 ms, Tf 3 ms
Temperature (operating/storage)	Operating 0°C – +40°C Storage -20°C – +60°C

Materials

Frame	Anodised Aluminium
Glass	Anti-reflective 2 mm. black edged glass

Connectivity

Input signal	DVI-I (1 input) – HDCP Compliant DVI-D (1 input) – HDCP Compliant
RJ45 CAT5 (with loop)	Addressable RS422 monitor control by AHnet protocol
GPI (SubD9)	Up/Down control

Control

RJ45, RS-422 (I/O)
Addressing
Termination switch
GPI
IR Remote control (monitor adjustments)

Movement's Control

User interface on monitor	(Up/Down)
Remote	RS-422 I/O/GPI

Electrical

Low voltage (external power supply)	100-240Vac, 47/63Hz, 12Vdc
Power consumption	50W

Mechanical

Monitor Dimensions:	
Screen	424 x 241 x 20 mm [16.69"x9.49"x0.79"]
Top frame	424 x 20 mm [16.69"x0.79"]
Housing below the table	525 x 607 x 80 mm [20.67"x23.90"x3.15"]
Weight	16.5 Kg / 36.3 lbs
Shipping Dimensions:	
Weight	17.5 Kg / 38.5 lbs
Shipping Box	625 x 175 x 715 mm

OPTIONS

- Touch screen
- Monitor housing anodised in different customised colours

CERTIFICATIONS

- CE

WARRANTY

- 2 years general warranty

ARTHUR HOLM

Albiral Display Solutions SL · Fàtima, 25 Sant Hipòlit de Voltregà 08512 Bcelona, Spain · +34 938 502 376 · marketing@arthurholm.com
www.arthurholm.com

Arthur Holm is a registered brand of Albiral Display Solutions SL. Specifications subject to change without previous notice.

CONNECTIVITY PANEL

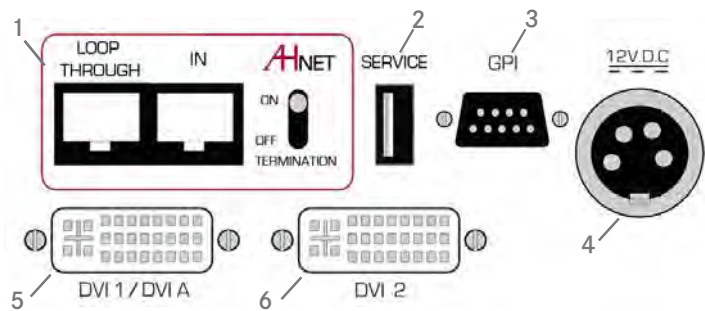

CONNECTIVITY

- 1- AHnet control interface
- 2- USB for service
- 3- GPI control
- 4- Power input
- 5- DVI 1 / DVI A video input
- 6- DVI 2 video input

INTERACTIVE SETUP DISPLAY

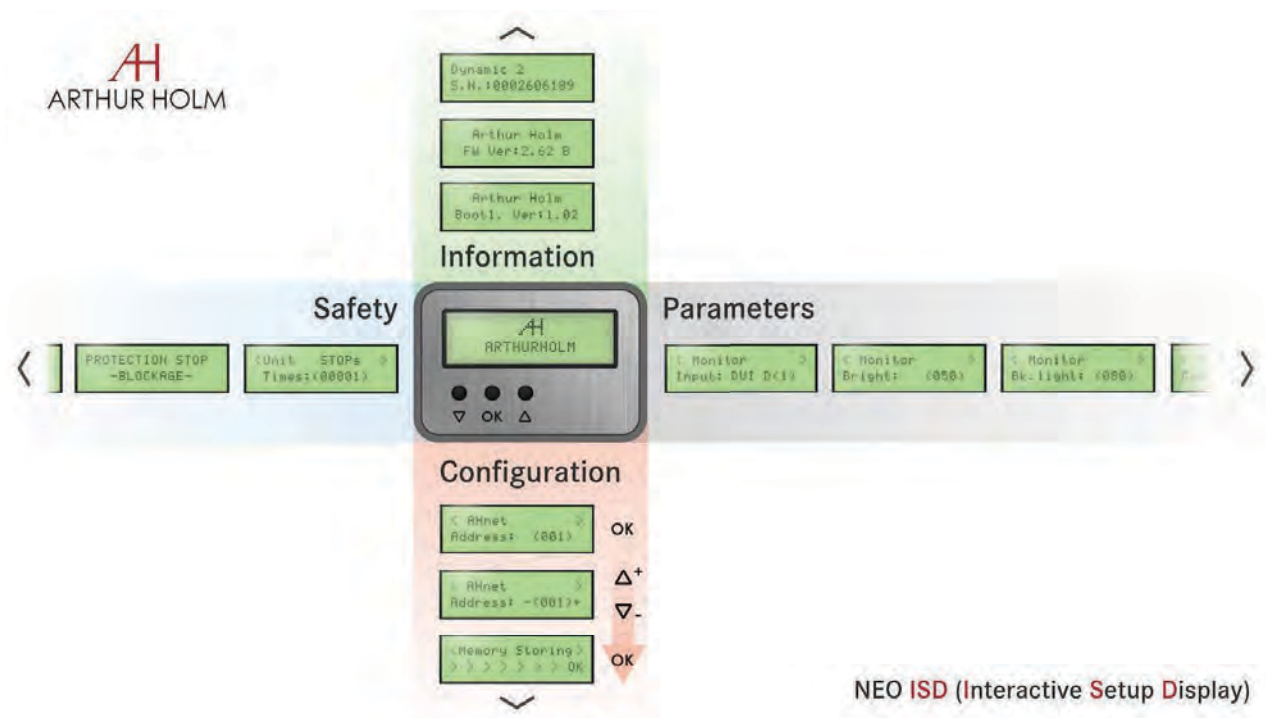

NEO ISD (Interactive Setup Display)

ARCHITECT'S SPECIFICATIONS

Retractable Full HD 17.3" screen with 20° of adjustable inclination. Low voltage. Solid aluminium monitor housing (anodised finish), square corner design featuring 2mm. double sided anti-reflective black edged glass. The screen features control sensors to raise, lower and adjust the viewing angle. One sensor is located on the top of the aluminium frame, which is accessible when the monitor is hidden within the table, and another sensor is placed in the front glass of the monitor. DVI-I and DVI-D connectors: HDCP compliant inputs. RS-422 I/O and GPI connector.

Easy to read Interactive Set-Up Display (ISD) 2.2" LCD display, allowing local and remote configuration, operation and troubleshooting without having to remove the monitor from the furniture. When connected to the AH ERT

interface, the assisted addressing system facilitates the address configuration by just simply pressing one button, in an easy and convenient way. Embedded speed and protection pre-sets for quick restore to factory values (enabling a rapid reset to factory values if required). Auto-check feature for auto-diagnostic and internal protection functions. USB port for local firmware upgrade. Safety system that detects obstructions (causing unit to stop).

Adjustable mechanical parameters through AHnet or ISD for calibration and adjustment of mechanics. Adjustable parameters of brightness, contrast and backlight through RS-422. External power supply with 4-Pin XLR4 connector.

ARTHUR HOLM

Albiral Display Solutions SL · Fàtima, 25 Sant Hipòlit de Voltregà 08512 Bcelona, Spain · +34 938 502 376 · marketing@arthurholm.com
www.arthurholm.com

Arthur Holm is a registered brand of Albiral Display Solutions SL. Specifications subject to change without previous notice.

GENERAL DIMENSIONS

AH17DB2

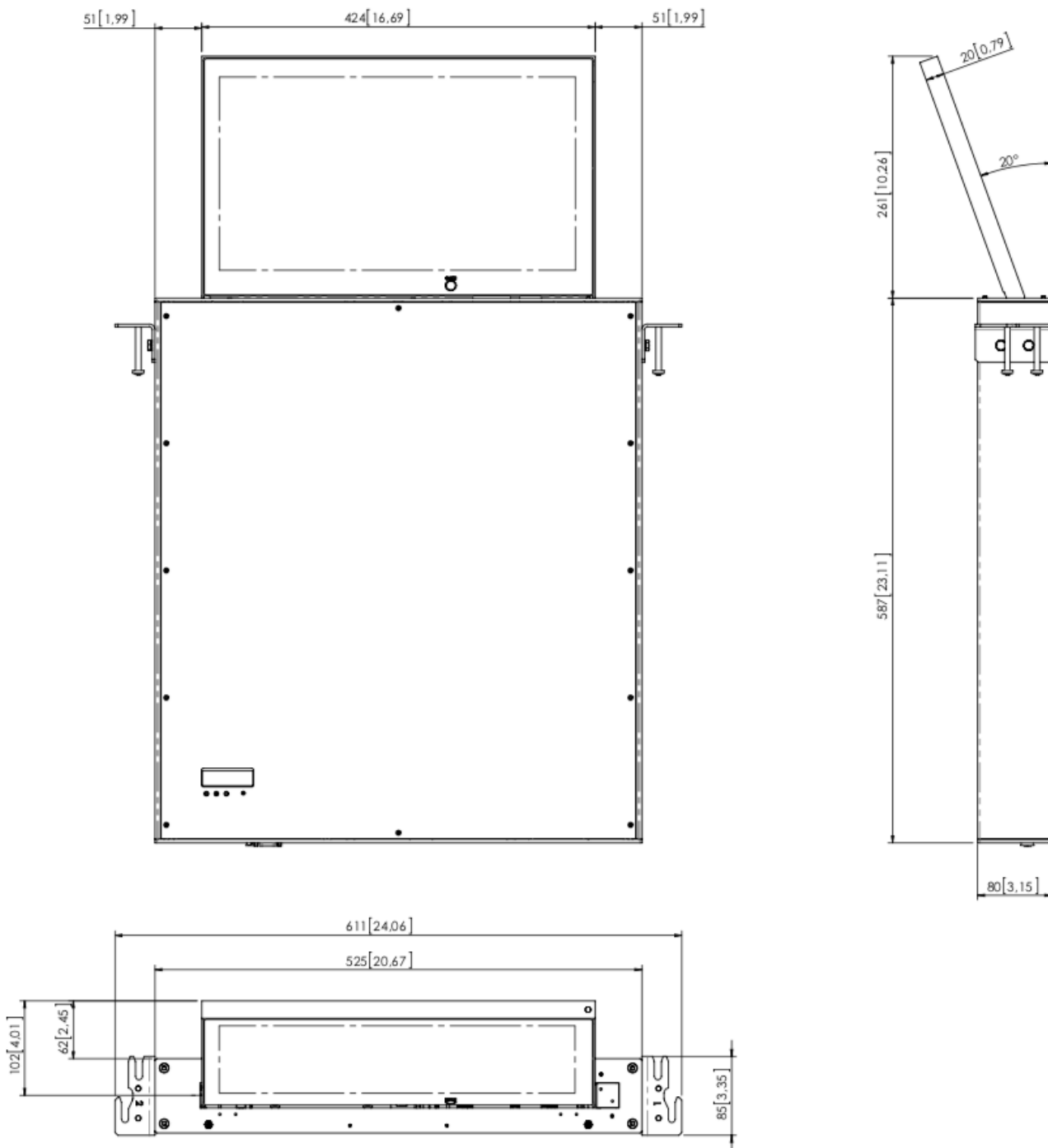

ARTHUR HOLM

Albiral Display Solutions SL · Fàtima, 25 Sant Hipòlit de Voltregà 08512 Bcelona, Spain · +34 938 502 376 · marketing@arthurholm.com
www.arthurholm.com

Arthur Holm is a registered brand of Albiral Display Solutions SL. Specifications subject to change without previous notice.