

## ERT-30

---



### Highlights

- OTAS (One Touch Addressing System)
- IP to RS422/RS485 interface
- 1 AHnet Port (RS-422)
- Maintenance free
- Controls up to 30 units
- AHlink wireless app for control and setup

### General

The ERT-30 interface provides an easy and convenient system to control, setup and diagnose motorized monitors, microphone lifts and other automated solutions by Arthur Holm.

The ERT-30 integrates a AHnet port (RS-422) to control up to 30 motorized units with a USB service port interface for firmware upgrade. The One Touch Addressing System (OTAS) makes the addressing of Arthur Holm motorized products to be straightforward. The first unit to be activated on the cover plate of the monitor after installation will have address No. 1, the next one will have address No. 2 and so on. OTAS is available on the majority of Arthur Holm motorized products.

The ERT-30 interface helps to reduce the installation costs in terms of both equipments and time. It is easy to install and set-up. It enables a quicker installation and eliminates the need of external relay boxes and extra power outlets. It is also possible to have Arthur Holm's virtual support on site as long as there is an Internet connection available. AHlink wireless control is also integrated in the ERT-30 interface, giving an easy and direct access to the most common settings through an app and making the start-up and future interventions hassle free. This means there is no need to access physically the unit to set-up or diagnose its installation

## Connectivity

Ethernet RJ45	Network connection
RS-422 and RS-485 RJ45	

## Wireless control

AHlink

## Electrical

External power supply	100-240Vac, 47/63Hz, 12Vdc
Power consumption	8 W

## Mechanical

Weight	1 Kg / 2.2 Lbs
Shipping Box	129 x 73 x 24.50mm [5.08" x 2.87" x 0.96"]

## Certifications

- CE
- FCC

## Warranty

- 2 years general warranty

## Consultants, architects and engineers specifications

The enclosure shall be built in coated painted steel. The unit shall interface IP (Ethernet) and RS422 (AHnet). The ERT shall support the daisy chain using CAT-6 allowing cables to have OTAS (One Touch Monitor Addressing). The unit shall integrate 1 AHnet port allowing to control up to 30 devices.

The unit shall provide a USB connector for firmware upgrades. The unit shall provide a dip switch for configuration. The unit shall be compatible with AHlink wireless app for control and setup.

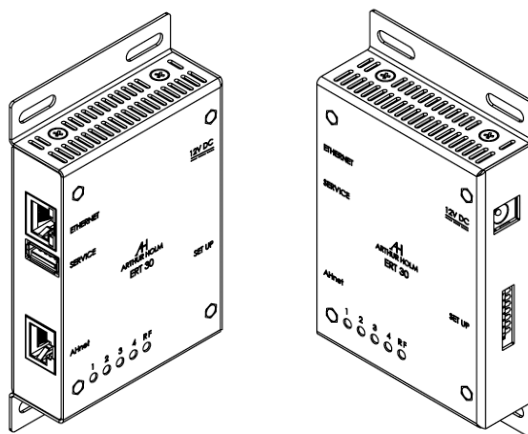
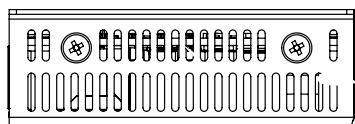
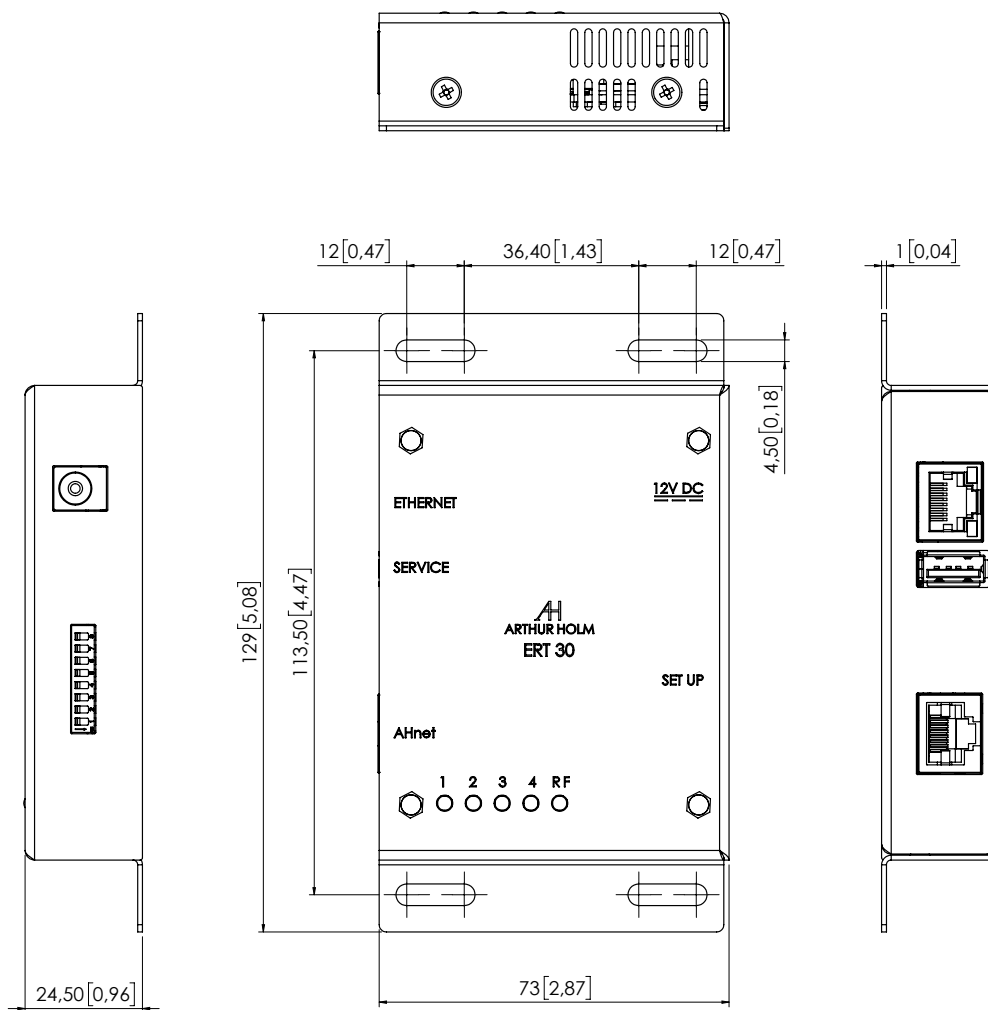

ARTHUR HOLM

Albiral Display Solutions SL · Fàtima, 25 Sant Hipòlit de Voltregà 08512 Barcelona, Spain · +34 938 502 376 · marketing@arthurholm.com · www.arthurholm.com  
 Arthur Holm is a registered brand of Albiral Display Solutions SL. Specifications subject to change without previous notice.

Technology serving Design