

## DynamicMCS

High-resolution motorized video camera, microphone and loudspeaker in one

AHDMCS C   AHDMCS C/CP   AHDMCS CA   AHDMCS CA/CP



Now you see me,  
Now you don't!

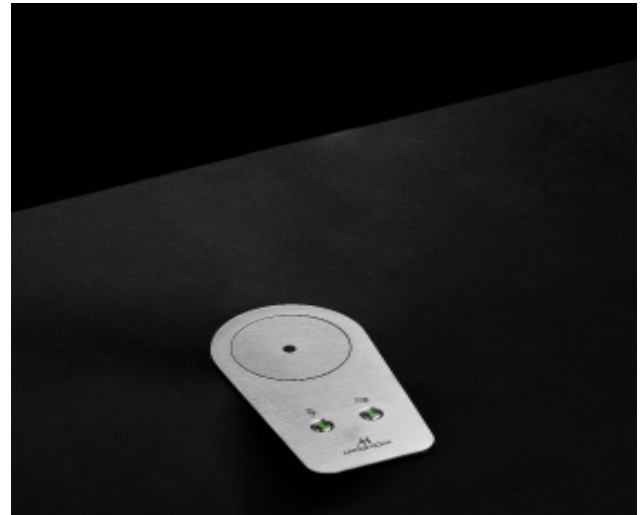

### Highlights

- Motorized pop-up video camera, microphone and loudspeaker for furniture integration
- Manual rotation 45° left and right
- Stainless steel cover top
- Camera: HD-SDI BNC out
- Microphone: analogue line output-terminal blocks connectors
- Active speaker: analogue line input-terminal blocs connectors
- 2-color controllable LED ring
- Up and down capacitive button
- Serial control and remote diagnosis
- Auto Mechanical Movement Calibration (AH-AMMC)
- Compatible wireless connectivity for setup and control via AHlink.

### General

Motorized high-resolution HD-SDI video camera, microphone and loudspeaker for furniture integration. Omnidirectional microphone with 1 audio output: balanced analogue line level via terminal block line (no phantom required). The hybrid camera housing is built in steel and composite materials in a black, non-reflective mat finish.

A capacitive touch button in the steel cover raises and lowers the camera, microphone and speaker. The camera can be turned manually 45° horizontally to each side. The DynamicMCS can also be remotely controlled via AHNet (RS-422/RS-485 Full Duplex) and GPI.

The DynamicMCS provides RS-422/ RS-485 Full Duplex allowing the remote control of movements, speed, and safety settings. The monitors are equipped with Auto Mechanical Movement Calibration (AH-AMMC). The use of Arthur Holm's ERT will enable the address configuration of all the motorized devices of the installation by simply pressing a button. The unit is compatible with the AHlink Android and iOS App allowing access to the setup, diagnose and control.

## Product Code

- AHD MCS CA/CP Camera, audio and cover plate w/buttons
- AHD MCS CA Camera and audio
- AHD MCS C/CP Camera, cover plate w/buttons only, no audio
- AHD MCS C Camera only, no audio

## Technical Specifications

### Materials

Cover plate	Stainless Steel
-------------	-----------------

### Control

Up /Down	Capacitive touch button
	GPI
Full Control	RS-422/RS-485 Full Duplex via AHnet protocol

### LED

Indicator for camera and microphone status
--

### Camera

HD-SDI, BNC Output	
Pickup Device 1/2.8 (D-6.46mm) Sony Color CMOS Sensor	
Total Pixels	2.16MP [1945 (h) x 1109 (v)]
Active Pixels	2.12MP [1937 (h) x 1097 (v)]
Min. Illumination	0.01Lux (F2.5-30IRE), 0.0003Lux (DSS on)
Video Out HD-SDI	1 0 8 0 p @ 2 5 / 3 0 , 720p@25/30/50/60
Angle of view	92.5°(d), 78°(h), 44.5°(v)

### Microphone

Built-in preamplifier with DSP process. Balanced line output (terminal block)

Sensitivity	1KHz, 94dB SPL = 1.4dBV
Acoustic Overload Point	124dB SPL

### Speaker

2 x 1.6" x 2.4" speaker
Class-D built-in 18W amplifier
DSP process
Balanced line input, level line +0dB (terminal block)

### Electrical

External Power Supply	100-240Vac, 50/60Hz, 12V 6.25A
Power Consumption	35W

### Mechanical

Housing below the table	101.25 x 101.25 x 661.50mm [3.99" x 3.99" x 26.04"]
-------------------------	---

## Options

- Optical Microphone (Mute) & Camera (OFF) buttons
- Control Panel with LED

## Certifications

- CE

## Warranty

- 2 years general warranty

### ARTHUR HOLM

Albiral Display Solutions SL · Fàtima, 25 · 08512 Sant Hipòlit de Voltregà · Barcelona, Spain · +34 938 502 376 · marketing@arthurholm.com · www.arthurholm.com  
Arthur Holm is a registered brand of Albiral Display Solutions SL. Specifications subject to change without previous notice.

Make Your Meetings Count!

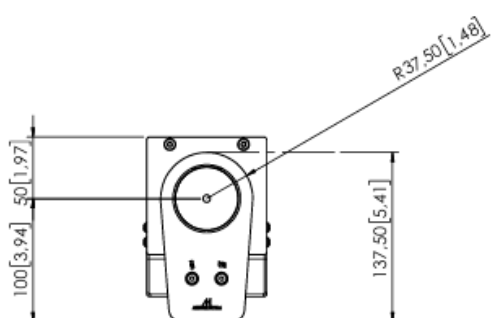
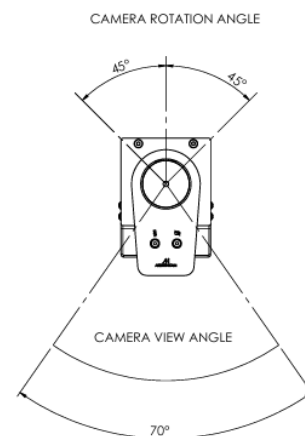
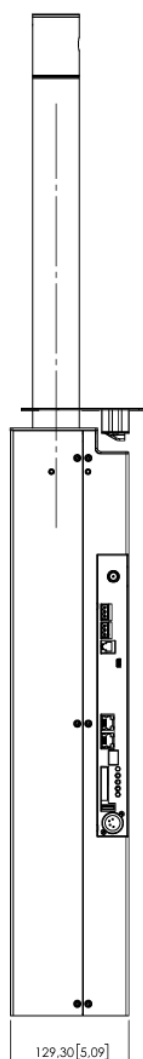
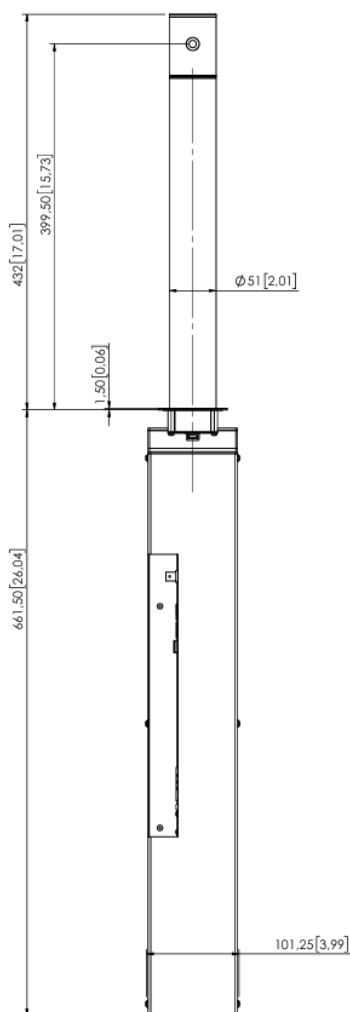

## ARTHUR HOLM

Albiral Display Solutions SL · Fàtima, 25 · 08512 Sant Hipòlit de Voltregà · Barcelona, Spain · +34 938 502 376 · [marketing@arthurholm.com](mailto:marketing@arthurholm.com) · [www.arthurholm.com](http://www.arthurholm.com)  
 Arthur Holm is a registered brand of Albiral Display Solutions SL. Specifications subject to change without previous notice.

**Make Your Meetings Count!**