

## ERT-60

---



### Highlights

- OTAS (One Touch Addressing System)
- IP to RS422/RS485 Full Duplex Interface
- 2 AHnet Ports (RS-422)
- Ethernet 100mbps
- Controls up to 60 units
- AHlink wireless app for control and setup

### General

The ERT interface provides an easy and convenient system to control, set up and diagnose motorized monitors, microphone lifts and other automated solutions by Arthur Holm. The ERT-30 integrates one AHnet port (RS-422/RS-485 Full Duplex) to control up to 30 devices and the ERT-60 integrate two AHnet port (RS-422/RS-485 Full Duplex) to control up to 60 devices. The ERT has a USB service port interface for firmware upgrade. The One Touch Addressing System (OTAS) makes the addressing of Arthur Holm motorized products to be straightforward. The first unit to be activated on the cover plate of the monitor after installation will have address No. 1, the next one will have address No. 2 and so on. OTAS is available on the majority of Arthur Holm motorized products.

The ERT interface helps to reduce the installation costs in terms of both equipment and time. It is easy to install and set-up. It enables a quicker installation and eliminates the need of external relay boxes and extra power outlets. It is also possible to have Arthur Holm's virtual support on site as long as there is an Internet connection available. AHlink wireless control is also integrated in the ERT interface, giving an easy and direct access to the most common settings through an app and making the start-up and future interventions hassle free. This means there is no need to access physically the unit to set-up or diagnose its installation.

---

#### ARTHUR HOLM

Albiral Display Solutions SL · Fàtima, 25 · 08512 Sant Hipòlit de Voltregà · Barcelona, Spain · +34 938 502 376 · [marketing@arthurholm.com](mailto:marketing@arthurholm.com) · [www.arthurholm.com](http://www.arthurholm.com)  
Arthur Holm is a registered brand of Albiral Display Solutions SL. Specifications subject to change without previous notice.

**Make Your Meetings Count!**

<b>Connectivity</b>	
Ethernet RJ45	Network connection
RS-422 and RS-485 Full Duplex RJ45	
Speed	Ethernet 100mbps
<b>Wireless control</b>	
AHlink	
<b>Electrical</b>	
External power supply	100-240Vac, 50/60Hz, 12Vdc
Power consumption	5W
<b>Mechanical</b>	
Dimensions	165 x 63 x 24.50mm [6.50" x 2.48" x 0.96"]
Weight	0.3kg / 0.66lbs

## Certifications

- CE
- FCC

## Warranty

- 2 years general warranty

## Consultants, architects and engineers specifications

The ERT-60 interface shall provide an easy and convenient system to control, set up and diagnose motorized automated solutions by Arthur Holm. The enclosure of the ERT-60 shall be built in coated painted steel. The unit shall interface IP (Ethernet) and RS-422/RS-485 Full Duplex (AHnet). The ERT-60 shall support the daisy chain using CAT-6 FTP allowing cables to have OTAS (One Touch Monitor Addressing). The unit shall integrate 2 AHnet ports allowing to control up to 60 devices.

The ERT-60 shall provide a USB service port interface for firmware upgrades. The unit shall provide a dip switch for configuration and shall provide AHlink wireless app for control and setup.

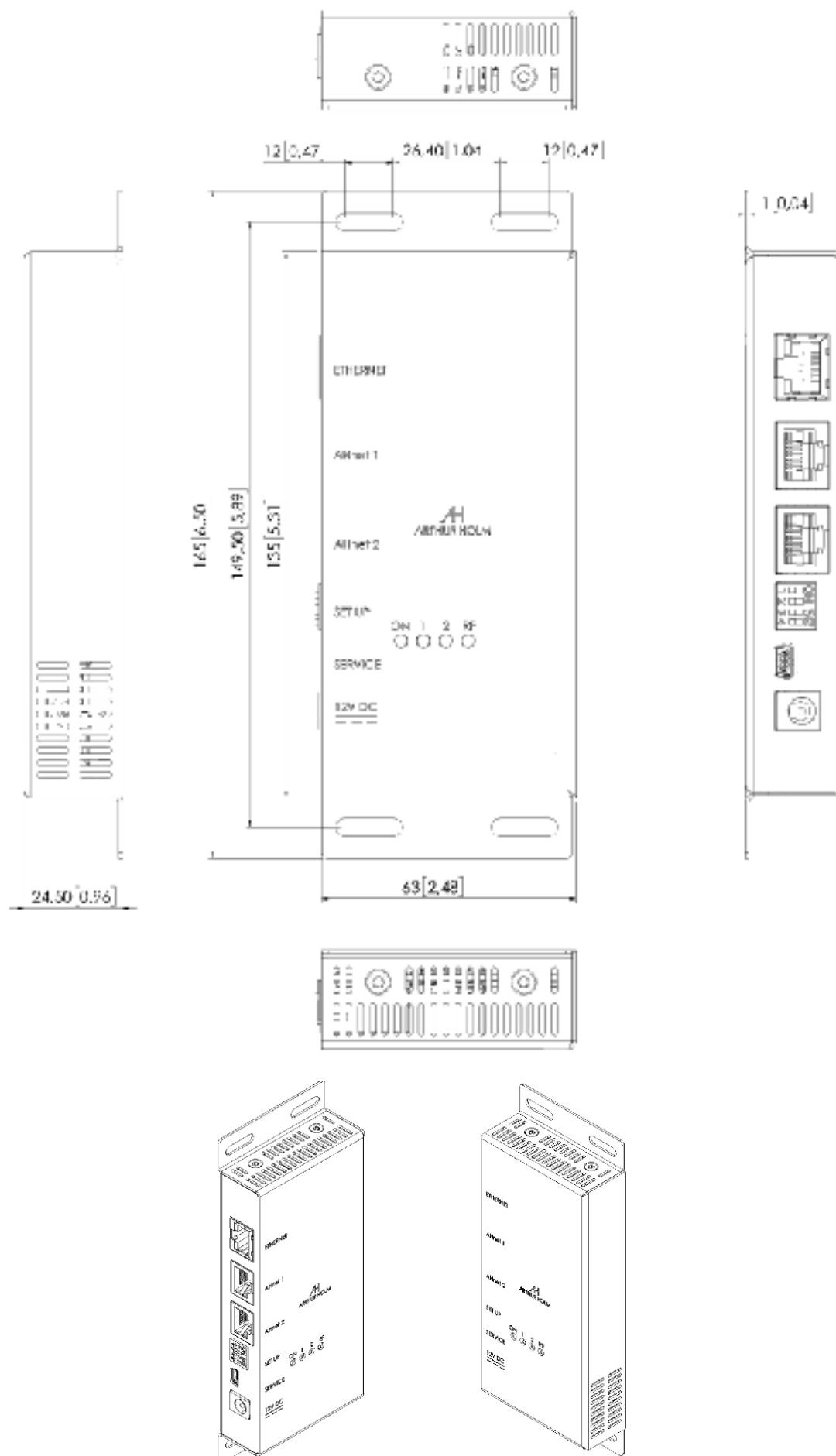

## ARTHUR HOLM

Albiral Display Solutions SL · Fàtima, 25 · 08512 Sant Hipòlit de Voltregà · Barcelona, Spain · +34 938 502 376 · [marketing@arthurholm.com](mailto:marketing@arthurholm.com) · [www.arthurholm.com](http://www.arthurholm.com)  
 Arthur Holm is a registered brand of Albiral Display Solutions SL. Specifications subject to change without previous notice.

Make Your Meetings Count!