



# User Guide



## **SMART retractable monitors**

**ALB17A2**

**ALB22A2**

HDCP compliant retractable monitors for furniture integration

Enhancing communication through technology

----- Trusted since 1985 -----



**TABLE OF CONTENTS**

EC REGULATIONS AND SECURITY	6
SAFETY INSTRUCTIONS	6
INTRODUCTIONS	8
CONTROLS	9
OSD MENU	10
INPUT CONNECTORS	13
INPUT SIGNALS	13
INFORMATION ON DISPOSAL	14
WARRANTY TERMS AND CONDITIONS	15



## WELCOME

Thank you for purchasing an Albiral product.

Our product range has been designed for a seamless integration and for a maximum reliability.

Please, read this installation and operating instructions carefully and keep them in a safe place for future reference.

We remain at your entire disposal if you have any suggestions that would help us improve our products.

**Henrik Holm**

General Manager

hholm@albiral.com



## EC REGULATIONS AND SECURITY



**ATTENTION:** Do not disassemble or modify the device in any way. This symbol warns of the presence of dangerous un-insulated voltages inside some of the components, of sufficient magnitude to expose people to risk of electronic shock.



This symbol draws attention to important use and maintenance instructions in the manual that accompanies the unit.



This symbol indicates that the equipment conforms to the norms established by the European Community.

## SAFETY INSTRUCTIONS

### Plugs

- Do not dismantle any part of the monitor power connector.
- Disconnect the power plug from the AC outlet when the monitor is not going to be used for an indefinite period of time.

### Power and extensions cords

- Use the appropriate power cord with the correct plug type.
- Do not overload wall outlets or power cords.
- Make sure the total ampere passed through a extension cord does not exceed the maximum allowed by the cable used.
- Do not place anything on the power cord.
- Do not locate this product where a person may walk or trip over the cord.
- The operating electrical outlet must be operating in an easily accessed place

## SAFETY INSTRUCTIONS



Wiring connected to hazardous voltage requires installation by qualified personnel or the use of ready-made flexible cables.



For your security, your equipment must be connected to an electrical outlet with grounding connection protection. Since the plug is used to disconnect the device, the operating electrical outlet must be in an easily accessible place.

### Environment

- Install the equipment on an elevated, flat surface.
- Install the equipment in a ventilated area.
- Avoid exposing the equipment to:
  - Rain or water
  - Excessive heat, cold or humidity
  - Area exposed to direct sunlight
  - Dirty areas
  - Equipment generating strong magnetic fields
- Avoid placing open containers of liquid, near the equipment.
- Keep a minimum distance of 30 mm in order to have good ventilation.
- Never place above the device any sources of flames such as lighted candles, etc.
- If you are using the device in extreme weather conditions and/or tropical climates, the equipment should be installed in a room which ensures a reasonable level of temperature and humidity.
- To prevent damage, the equipment must be firmly anchored to the surface, as shown in the installation instructions.

# INTRODUCTIONS

## Check List

Before operating this monitor, please make sure that all items listed below are present in your package:

- The monitor unit
- This user's manual
- AC power cord
- External power supply

## Features

Signal input: HDMI HDCP compliant

- ALB17A2 17''FULL HD panel
- ALB22A2 22'' FULL HD panel

## Manual Movement

When closing, the device must be gently accompanied

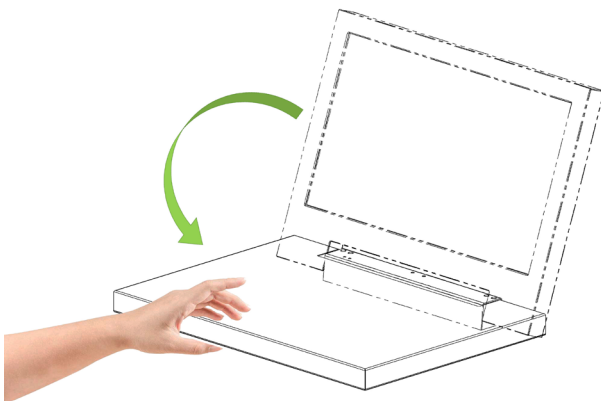



## CONTROLS

The OSD (On Screen Display) buttons, to control or configure the monitor, are placed on the lower body housing of the system

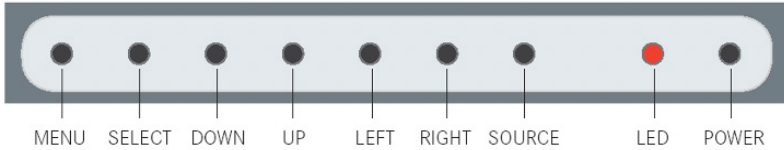

OSD monitor control:

POWER	Monitor power ON/OFF the monitor
LED	Indicates operation status
SOURCE	Signal input selection (not used on this model)
UP	Cursor control up on the OSD menu
DOWN	Cursor control down on the OSD menu
LEFT	Cursor control left on the OSD menu
RIGHT	Cursor control right on the OSD menu
SEL	Selects the OSD menu function
MENU	Activates OSD menu. Exits OSD menu when is active

The monitor is switched off when it is closed (horizontal position).

## OSD MENU

### Accessing the menu system

- With the OSD off, push the MENU button to activate the main OSD menu.
- Press the UP and DOWN buttons to move from one function to another. Please refer to the following sections below to view a complete list of all the functions available for the monitor.
- Press the OK button to enable the item.
- When a function is selected, press the LEFT and RIGHT buttons in order to change the parameter of the function.

Press the Menu button to access to the main menu.

### Picture

PSM: Adjusts the mode of the image

- Dynamic
- Standard
- Mild
- User (manually adjustment of brightness and contrast):

Contrast - Brightness - Colour - Sharpness - Tint

CSM: Adjusts the colour of the image

- Cool
- Medium
- Warm
- User (manually adjustment of red, green and blue colours)

Aspect Ratio: Adjusts the image aspect on screen

- 4:3
- 16:9
- Just scan

## OSD MENU

Noise Reduction: Adjusts the image noise filter

- Off
- Low
- Medium
- High
- Default

Screen (Only for analogue signals):

- Auto Adjust
- Horizontal Position
- Vertical Position
- Size
- Phase

Backlight: Adjusts the backlight screen level

Colour Range: Adjusts the colour range

- 0 - 255
- 16 - 235

## OSD MENU

### Option

Language: OSD language selection

Restore Factory Default: Adjusts the parameters to the initial factory parameters

Blending: OSD window transparency

- Low
- Medium
- High
- Off

OSD Duration: Adjusts the time that the OSD menu window remains on screen

Software Update: Used for firmware upgrade mirror

Mirror:

0. Image with no flip
1. Vertical flip
2. Horizontal flip
3. Rotate

# INPUT CONNECTORS

The monitor has two cables:

Power cable: Power input 12Vdc. Connect the power supply delivered with the unit

Signal cable: HDMI female cable. Connect the input signal

# INPUT SIGNALS

RESOLUTION	Horizontal freq (KHz)	Vertical freq (Hz)	Scanning type
800x600@60Hz	37.879	60.317	Progressive
800x600@72Hz	48.077	72.188	Progressive
800x600@75Hz	46.875	75.000	Progressive
1024x768@60Hz	48.363	60.005	Progressive
1024x768@70Hz	56.476	70.070	Progressive
1024x768@75Hz	60.023	75.030	Progressive
1280x720@60Hz	44.772	59.855	Progressive
1360x768@60Hz	47.720	59.799	Progressive
1280x1024@60Hz	63.981	60.020	Progressive
1600x1200@60Hz	75.000	60.000	Progressive
1680x1050@60Hz	64.742	59.946	Progressive
1920x1080@60Hz	66.647	59.980	Progressive

## INFORMATION ON DISPOSAL FOR USERS OF WASTE ELECTRICAL & ELECTRONIC EQUIPMENT



This symbol on the products and/or accompanying documents means that used electrical and electronic products should not be mixed with general household waste.

For proper treatment, recovery and recycling, please take these products to the designated collection points, where they will be accepted on a free of charge basis. Alternatively in some countries, you may be able to return your products to your local retailer upon the purchase of an equivalent new product.

Disposing of this product correctly will help save valuable resources and prevent any potential negative effects on human health and the environment, which could otherwise arise from inappropriate waste handling. Please contact your local authority for further details of your nearest designated collection point.

Penalties may be applicable for incorrect disposal of this waste, in accordance with national legislation.

### **For business users in the European Union**

If you wish to discard electrical and electronic equipment, please contact your dealer or supplier for further information.

### **Information on disposal in countries outside the European Union**

This symbol is only valid in the European Union. If you wish to discard this product, please contact your local authorities or dealer and ask for the correct method of disposal.

## WARRANTY TERMS AND CONDITIONS

Albiral Display Solutions S.L., with this document, guarantees all Albiral and Arthur Holm Trademark LCD/TFT monitors.

Against defects in manufacturing in accordance with the following conditions:

1. This guarantee covers the original product purchaser for a period of 24 months from the date of purchase.

2. This guarantee covers:

a) Parts: During the warranty period, the replacement of any electronic and mechanical parts against any defects in manufacturing. The guarantee does not cover any faulty electronic and/or mechanical components arising from incorrect installation, non-authorised modification, and inadequate transport or as a result of atmospheric phenomenon.

b) Labour: Albiral Display Solutions S.L covers labour costs for replacement of any defective parts (in accordance to paragraph 2a) during the period of this warranty.

c) Transport costs:

I) In the case that a manufacturing defect occurs within 30 days after the purchase date, both freight and insurance will be paid by Albiral Display Solutions, S.L.

Although Albiral Display Solutions pays for transport and insurance cost, Albiral Display Solutions will not be responsible for the damages caused by transport if the customer does not inform in writing immediately when receiving the goods.

II) After 30 days of the purchase date, both freight and insurance costs will be paid by the customer.

d) Albiral Display Solutions S.L. will not be responsible for the damages caused by transport, when this is paid by customer.

## WARRANTY TERMS AND CONDITIONS

e) The guarantee is not valid if persons other than authorised service Centre have handled the product and if the product has been manipulated.

f) The beneficiary of the Guarantee will have to send the devices with the original packaging or an appropriate one to guarantee there are no damages during the transport.

g) The guarantee is not valid if the customer does not include RMA form and copy of the purchasing invoice

3. Albiral Display Solutions S.L. recognized all guaranteed user rights by all legal rules from its region, and in the absence of them, all established consumer rights by general law 26/84.

Please note that laws vary from country to country, and the same provisions of this warranty may not apply to you.

If you have any doubts concerning the terms of this warranty, please contact:

[business@albiral.com](mailto:business@albiral.com)

+34 938 502 376

Copyright ©

Dec. 2020. All rights reserved

Albiral Display Solutions SL.

Registered trademarks: Albiral, Arthur Holm, Pixtron Broadcast









## Albiral Display Solutions

Fàtima 25, Sant Hipòlit de Voltregà  
08512 Barcelona – Spain  
tel: +34 93 850 23 76 / 23 83  
fax: +34 93 850 25 50 / 23 72  
web: [www.albiral.com](http://www.albiral.com)  
e-mail: [business@albiral.com](mailto:business@albiral.com)

### Patents

MU17180ES00	P27178ITEP
MU17301ES00	P27178RUPC
MU17322ES00	P27178USPC
MU17413ES00	P27284DEEP
MU17445ES00	P27284EPPC
MU17854ES00	P27284ESEP
MU17868DEPC	P27284GBEP
MU17868RUPC	P27284RUPC
P24821DEEP	P27284USPC
P24821ESEP	P27715ESEP
P24821GBEP	P28089DEEP
P24821USPC	P28089ESEP
P27178DEEP	P28089ITEP
P27178EPDV01	P28089USPC
P27178EPPC	P28090EP00
P27178ESEP	P31160ESES
	P31160PCES